

Charm Elements

PACK #1

2 NP212 Newsprint Sheets ~ 1 16" Compass Rose Block per Sheet
 1 NP211 Newsprint Sheet ~ 2 Flying Geese Borders per Sheet
 1 NP215 Newsprint Sheet ~ 4 Flying Geese Borders per Sheet

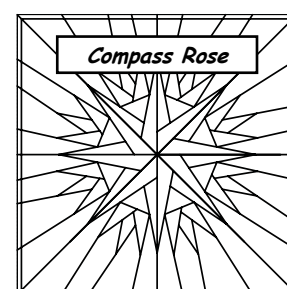
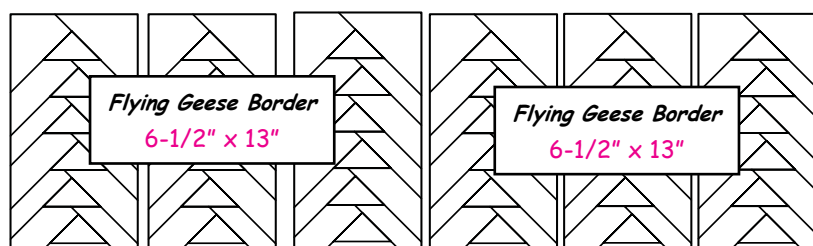
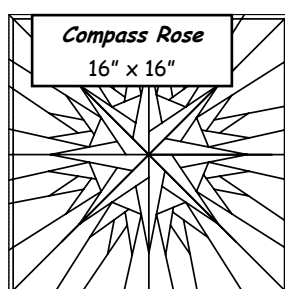

Fabric Requirements for (1) Compass Rose, Units JTCL and JTCR:

1. Background, Sec. 1, 3, 7, and 8: 1/2 Yd.
2. Accent, Sec. 2: 1/8 Yd.
3. Accent, Sec. 4 and 5: 1/8 Yd.
4. Background, Sec. 6: 1/8 Yd.
5. Accent, Sec. 9: 1/8 Yd.
6. Accent, Sec. 10 (Unit JTCL): 1/8 Yd.
7. Accent, Sec. 10 (Unit JTCR): 1/8 Yd.

Yardage for Two Compass Rose Blocks: If you are making a project with more than 1 Compass Rose, double the yardage for Colors #1 and #2. The rest of the yardage will be adequate for two blocks. For 3 blocks (if you purchase 2 packages), triple the yardage for Colors #1 and #2, and double the yardage for the rest. Four blocks would require 4 times Colors #1 and #2, and only 2 times each of the rest, and so on and so forth.

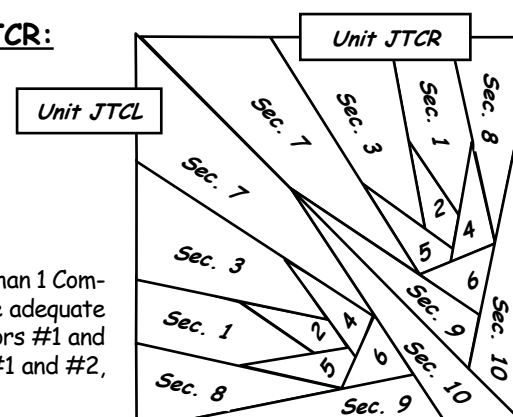

Fabric Requirements for (1) Flying Geese, Unit JTA:

1. Flying Geese Background: 3/8 Yd.
2. Flying Geese: 1/8 Yd.

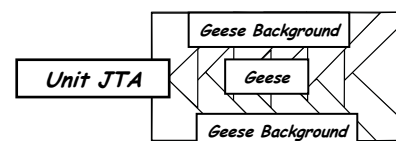

Yardage for Two Flying Geese Blocks: The yardage above must be purchased for 1 Flying Geese Block, but there is enough fabric left over to complete (2) Flying Geese Blocks, if desired. To make 3 or 4 flying geese blocks, double the yardage. To make 5 or 6 flying geese blocks, you will need to triple the yardage.

Quiltworx.com

E-mail: info@quiltworx.com

homepage: www.quiltworx.com

Visit our facebook, pinterest, and youtube pages: Quiltworx.com

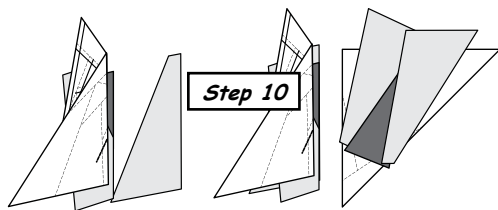

Continue adding the fabric pieces to complete each section on the foundation paper. Make sure the fabric pieces cover the section they were intended to cover before you fold back and trim the next seam.

When the foundation piecing for the JTCL Units is complete, you will have (4) completed blocks to complete (1) Compass Rose. Repeat Steps 1 through 10 for Unit JTCL in Bag #2 and JTA in Bag #3. An example of how many units are required to finish (1) Compass Rose and (1) Flying Geese Border is below. This package contains enough papers to complete up to (2) Compass Rose blocks and (6) Flying Geese.

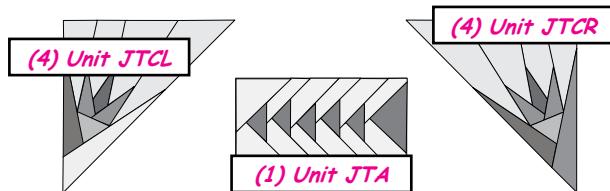

Sewing Your Project Together

When the blocks are complete, it is time to begin sewing your project together. The Flying Geese Border is already completed to the dimensions of a finished block.

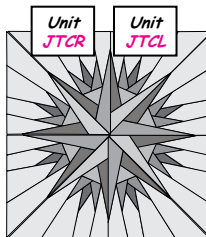

The Compass Rose, however, must be constructed first into (4) squares, then the (4) squares must be sewn into a 4-patch. Press all of the seams on the back of the block in the same direction (clockwise, for example). At the intersection in the middle, pick back a few stitches and fan the intersection in a small star, twisting the opposite direction to the pressing, so that the intersection lays flat. You now have a completed Compass Rose block and a completed Flying Geese Border block.

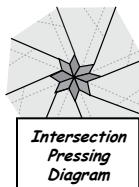

Use the completed units as a component of any variety of projects that could be completed with the smaller blocks. As noted earlier in the pattern, these blocks are designed to fit a purse designed by Totes By Sandy. Additionally, they are used in a variety of Cutloose Press designs that incorporate a variety of additional layouts for this Charm Pack and others. They can also be used in your own unique project! If you are creating something that references another pattern, you can find additional layout and project assembly instructions there. If you are creating something unique, it's up to you to take it from here!

Pattern Information: Scan the code in the bottom left corner to find information specific to this pattern including:

1. *Cutloose Press (Layout) Patterns (as available),*
2. *Other Related Layout Products,*
3. *Layout Pattern Yardage Requirements,*
4. *Corrections (if any),*
5. *Projects by Customers using this Package, and*
6. *Workshops with teaching information!*

General Supply List:

Steam Iron
Ironing Board
Medium Size Cutting Board
6" by 24" Ruler
Small Scissors
Rotary Cutter
Seam Ripper
Microtex Sharps (sz 70) Sewing Needles
A high-quality Sewing Thread
Sewing Machine with Quarter-inch Foot.

Paper Piecing Supply List:

12" or 18" *Add-A-Quarter* ruler
Scotch tape
Glue Pen
Flower pins
Purple Thang
Template Plastic
Plastic bags for organization
Small binder clips, and
Large paper clips

PACKAGE CONTENTS:

- 1) Foundation papers, templates, and Template Layout Sheets to complete the number of blocks identified on the coversheet.
- 2) Basic Instructions for using the cutting templates and completing the foundation paper piecing.
- 3) Basic Introductory Information to the Paper Piecing process and helpful reminders as you construct your blocks.

THIS PATTERN DOES NOT INCLUDE LAYOUTS AND YARDAGE FOR SPECIFIC PROJECTS!

© Copyright April 2013

All rights reserved. No part of this pattern can be reproduced in any form for any commercial purpose without the expressed written permission of Judy Niemeyer Quilting. The written instructions, foundation papers, graphics, and photographs for the Charm Elements Pack #1 were designed as a package for the purpose of retail sales and as a result, fall under the protection of the federal copyright laws of the United States of America. Extra materials may be obtained from local quilt shops or directly from Judy Niemeyer Quilting.



Quiltworx.com
Judy Niemeyer Quilting

E-mail: info@quiltworx.com homepage: www.quiltworx.com

Visit our facebook, pinterest, and youtube pages: Quiltworx.com

