

**Step 2:** Fold open the papers and sew on the lines to complete the paper piecing for the corners.

**Step 3:** The corner pieces are pressed, then the excess fabric is trimmed off around each corner.

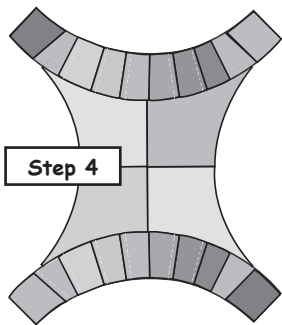
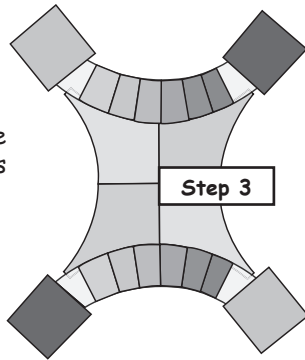

**Step 4:** The foundation papers are removed from each B-Units in Groups 1 & 2.

**Scalloped Edge Pieces**

**Top & Bottom Group 3**  
104" Make (8) Sets    118" Make (9) Sets

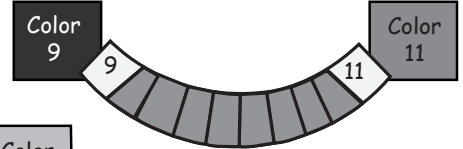

**Side Group 4**  
104" Make (2) Sets  
118" Make (2) Sets

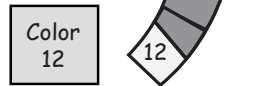

**Step 5:** The corner fabrics are sewn under the folded back corner sections to complete the paper piecing on both Groups 1 & 2.

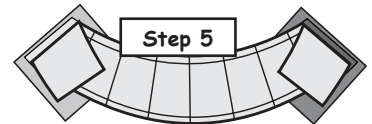

**Step 6:** The corner pieces are pressed and trimmed around each corner.

**Step 7:** Remove the foundation papers from the B-Units in Group 3 & 4.

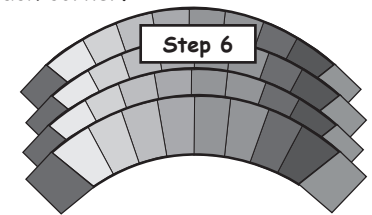

\*Refer to the directions on Page 10 for additional information about the placement for the A and B Units under the heading **Unit Groups 1, 2, 3, & 4**

*Group 1, G-1: Vertical Setting  
Group 2, G-2: Horizontal Setting  
Group 3, G-3: Top/Bottom  
Group 4, G-4: Sides*

**Illustration #1**

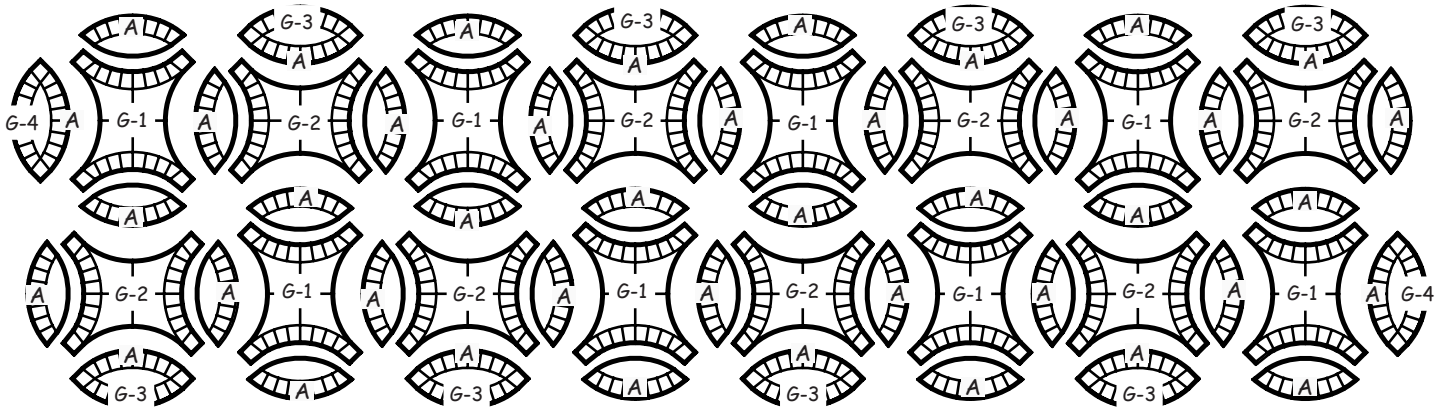

**Illustration #2**

